

Legend

- Red line site boundary**
- SOFT LANDSCAPE**
- Existing trees, hedgerow and water courses** to be retained and protected (Refer to Landscape and Arboticultural reports)
- Proposed Trees, Multi-Stem Trees and Ornamental Shrubs** including: Street trees: Downy Birch, Maidenhair Tree, Sweetgum, Ornamental Pear, etc. Rain Garden trees: Alder, Birch, Hazel, Spanish Oak, etc. Parkland trees: Oak, Horse Chestnut, Beech, Aspen, Cherry Tree, Rowan, Whitebeam, etc. Fruit Trees: Pear tree, Apple tree, Plum and Cherry. Boundary Screening trees: Holly, Hawthorn, Blackthorn, Silver Birch, Oak, Ornamental Shrubs: Hydrangea, Hawthorn, Elder, Myrtle, Common Juniper. (Refer to planting schedule)
- Native Boundary Woodland mix** @cig 2L 80-100 cm ht. Crataegus monogyna** Prunus spinosa** Ilex aquifolium** Rosa canina**
- Ornamental Planting Mix** 150mm topsoil depth Mix of ornamental grasses to provide all year round flow and texture in planting beds, including: Cornflowers, Sea Holly, Foxgloves, Russian Sage, Golden Oats, Tufted Hair Grasses, Terracotta Yarrow, etc.
- Rain Gardens Planting Mix** Ornamental adapted planting mix, including: Yellow Yris, Chinese Silver grass, Aidenworf, Gold Dew tufted Hair Grass, Reed grasses, etc.
- Amenity Grass Areas** 150mm topsoil depth
- Native Ecological Habitat Seed Mix** These mixtures contain 70% grasses with 30% long lasting perennial wildflowers. They are specifically designed for habitat restoration projects with the aim of providing maximum benefit to biodiversity. Each mix contains over 15 native species.
- Wetland Wildflower (Seasonally Flooded)** These mixtures has been specially selected to establish a native wildflower meadow on soils that remain damp year round and may experience some flooding such as a pond edge. Each mix contains over 22 native species.
- Blue Sedum Roof** Common Sedum species used include Sedum acre, S. rupestre, and S. album mixed with native/pollinator friendly perennials such as fox glove, Rudbeckia, Armeria, Dianthus, Helictotrichon sempervirens, Stipa tenuissima.

- SUDS**
- Bioretention Area / Detention Basin** Designed for water management while providing aesthetic appeal. Plant species in these areas are capable of withstanding floods and excess water while also attracting pollinators to promote biodiversity. This mix includes: Meadowsweet, Filipendula ulmaria, Flag Iris, Iris pseudacorus, Marsh Marigold, Caltha palustris, Purple Loosestrife, Lythrum salicaria, Bog Cotton, Eriophorum angustifolium, Water Mint, Mentha aquatica
- Rain Gardens / Bioretention Rain Gardens** Functional solution for stormwater attenuation to engineers specifications
- Swale** Refer to engineers detail drawings
- HARD LANDSCAPING**
- Asphalt Roadway** with in-situ concrete kerbs (to Engineer's specification)
- Car Parking Spaces** Permeable paving
- HomeZone & Raised Table** Permeable paving / Coloured asphalt
- Cycleway** Coloured Asphalt
- Public Footpaths** In-situ concrete, Brushed Finish, concrete slabs
- Footpaths - Main Parks** Buffed colour asphalt
- Bio-retention Park - Running Track** Coloured asphalt with with painting
- Asphalt footpaths** With painting where indicated
- Paving - Entrance to Houses and Communal Open Spaces** Permeable block paving

- Safety Surface - Playground / Fitness** Engineered woodchip
- Safety Grass Matting** Playground / Fitness safety surface
- Ecological Walkway observatory / Steel Bridge** Steel mesh panel platform bridge
- Grasscrete** Concrete grass
- Furniture and Features**
- Fitness/ Play Equipment** supplied by Kompan.com (Refer to Landscape Design Rationale)
- #71 Cycle Stand** supplied by Omos.ie
- Feature Seating Elements** Bespoke timber seats Selected seating elements
- #59 2ss Seat** supplied by Omos.ie
- #96w Picnic Set** supplied by Omos.ie
- Communal / Private Bins Storage** As per architecture details
- Communal / Private Bike Storage** As per architecture details
- Lighting** Refer to lighting plan and report

Context Plan



Reference Images

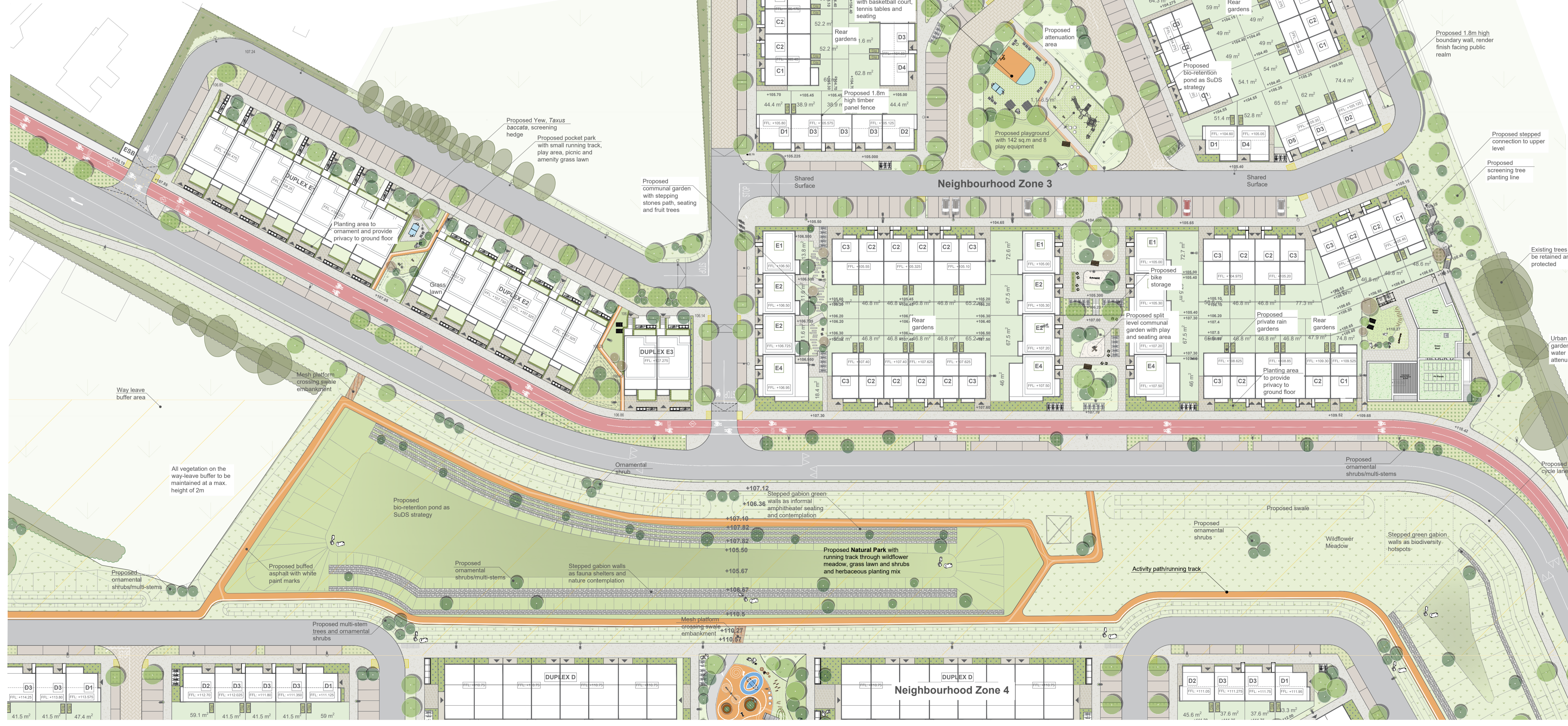
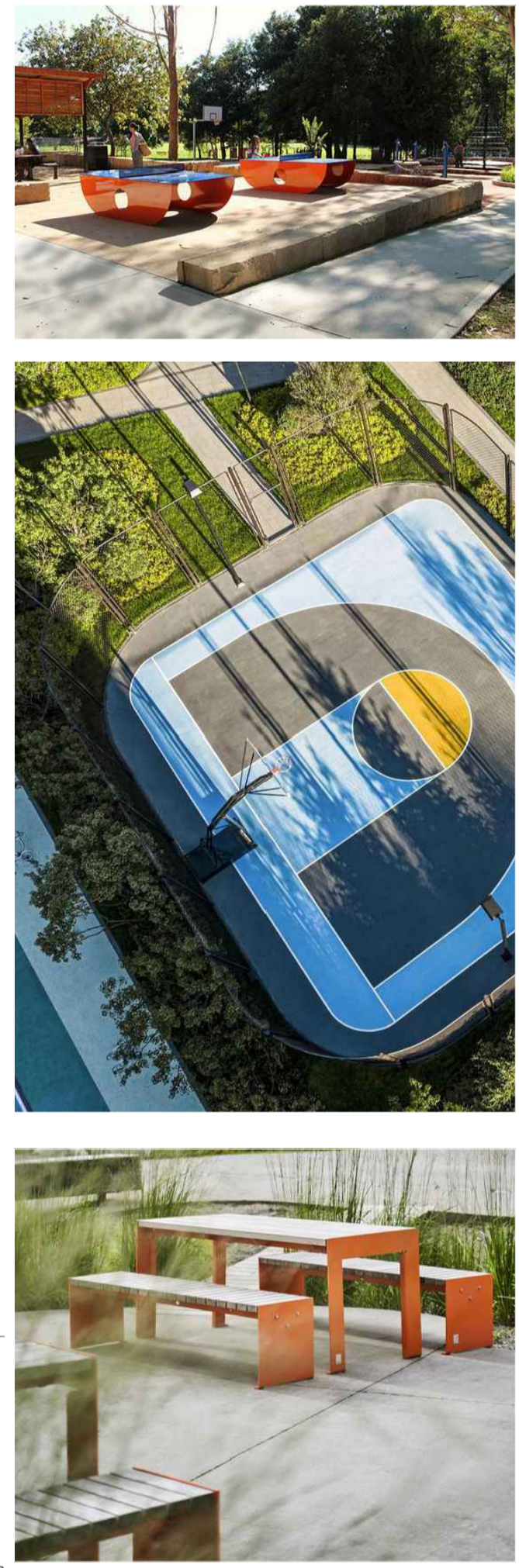

g+a Landscape Architecture

+353 84 128 1923
+info@gannondassociates.ie
+gannondassociates.ie

+Terenure Enterprise Centre, 17
Rathfarnham Rd, Terenure, Dublin,
D6W X921

REV	DATE	REVISION	DRAWN	CHECKED
E	14/08/2024	Issued for Planning	AP	JG
D		Issued for Comments	AP	JG
C	07/12/2023	Issued for Planning stage 1	AP	JG
B	04/12	Issued for discussion	AP	JG
A	21/11	Issued for discussion	AP	JG

CLIENT
CAPAMI LTD
PROJECT TITLE
Oldcourt Proposed Development, Oldcourt road, Ballycullen, Co. Dublin
PROJECT ARCHITECT
Davey + Smith Architecture
SHEET TITLE
Landscape Detail Area 5
SHEET NO.
23130_LP_DT05
SHEET SIZE
A1
SCALE
1:500
REVISION
E
STAGE
DATE
Planning Application
Aug 2024